



Diversity

from standard to **Exotic**

Keystone system

More than 70 modules

Network modules

Accessories

Patch Panel and Mounts

The Keystone House

Secure with system

Easy USB

RJ45 Cat.8

DELOCK[®]

we move the world



More than 70 modules

86381 ● **86379** ○

RJ45 female >
RJ45 female
Cat.6 UTP



86408

RJ45 female >
RJ45 female Cat.6A
metal



The Delock Keystone system can be used for many custom applications and is very versatile. There are currently more than 70 modules available - a diversity, which can solve any connection task quickly and easily.

86204 Cat.5e **86210 Cat.6**

RJ45 female >
RJ45 female



86141 Cat.6 **86166 Cat.6A**

RJ45 female >
RJ45 female



86288

RJ45 female Cat.6A



86488

RJ45 female Cat.8



86154

RJ45 female >
LSA Cat.6

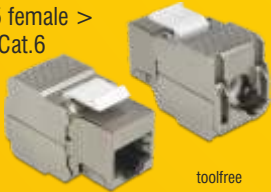

86179

LSA Cat.6A compact >
RJ45 female



86267 ● **86266** ○

RJ45 female >
LSA Cat.6A UTP



86168 ● **86198** ○

RJ12 female >
LSA Cat.3



86390 ● **86380** ○

RJ12 female >
RJ12 female Cat.3



86349 ●

RJ45 female >
LSA Cat.6 UTP

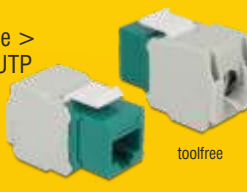

86321 ● **86314** ○

Keystone cover
(Set of 4)



86348

ST Simplex female >
ST Simplex female



86331

SC Simplex female >
SC Simplex female



86372

FC Simplex female >
female



86333

Keystone cover with
Hex hole for cables
(Set of 4)



86346

MTRJ female >
MTRJ female



86347

LC Duplex female >
Multimode female



86357

LC Duplex female >
Singlemode female



86315

Keystone cover with
D hole for cables
(Set of 4)



86350 ● **86300** ○

F female >
F female



86327 110° **86329** 250°

USB 2.0 A female >
USB 2.0 A female with cable



86326 110° **86328** 250°

HDMI female >
HDMI female with cable



86323

Terminal Block >
Terminal Block



86351 ● **86301** ○

BNC female >
BNC female



keine
Aufbauhöhe

86374 110°

mini Displayport female >
mini Displayport male
with cable



86375 250°

USB 3.0 A female >
USB 3.0 A male
with cable



86322 ○ **86336** ●

jack 3,5 mm 3 pin
female > female



86352 ● **86302** ○

IEC female >
F female



86367 ● **86317** ○

USB 2.0 A female >
USB 2.0 A female



86366 ● **86316** ○

HDMI female >
HDMI female



86383 ● **86363** ○

jack 3,5 mm 4 pin
female > female
(gold plated)



86334
IEC female >
F female



keine
Aufbauhöhe

86370 ● **86320** ○

USB 2.0 B female >
USB 2.0 A female



Beidseitig
einsetzbar

86358 ● **86359** ○

HDMI female >
HDMI female
90° angled



86337
TOSLINK female >
TOSLINK female



86362
IEC male >
F female



86354 ● **86364** ○

USB 2.0 A female >
USB 2.0 A female
90° angled



86369 ● **86319** ○

USB 3.0 A female >
USB 3.0 A female



86305 ● **86306** ○ **86307** ○

Cinch female >
Cinch female



86335
IEC male >
F female



no
installation
dept

86368 ● **86353** ○

EASY-USB 2.0 A
female > female



86360 ● **86361** ○

USB 3.0 A female >
USB 3.0 A female
90° angled



86303 ● **86304** ●
binding post > thread nut
(gold plated)



86356
RP-SMA female >
RP-SMA female



86338
Mini-DIN 4 pin female >
Mini-DIN 4 pin female
S-Video
(gold plated)



86324
FireWire A female 6 pin >
FireWire A female 6 pin



86308 ● **86309** ○ **86310** ○

RCA female >
RCA female
(gold plated)



86365
SMA female >
SMA female



86339
Mini-DIN 6 pin female >
Mini-DIN 6 pin female
gold plated (PS/2)



86355
DC 5,5 x 2.1 mm female >
solder connector



86373
DC 5,5 x 2.5 mm female >
solder connector



Keystone modules: maximum width

assembled patch panel rear view



Some mountings can only be used with "narrow" modules. The following dimensions (**max. width**) should be considered when selecting a mounting.

Modules

black	white	name	construction height	width
86321	86314	Cover (Set of 4)		16.3
	86315	Cover with D hole for cables (Set of 4)		18.0
	86333	Cover with Hex hole for cables (Set of 4)		16.3
86351	86301	BNC female > BNC female		18.0
	86306+307	RCA female > RCA female		18.0
	86308-310	RCA female > RCA female gold plated	9.5	16.3
	86355 NEW	DC 5.5 x 2.1 mm female > solder connector	3.0	16.3
	86373 NEW	DC 5.5 x 2.5 mm female > solder connector	3.5	16.3
86368	86353	Easy USB 2.0 A female > Easy USB 2.0 A female		17.3
86350	86300	F female > F female	8.1	16.3
	86372 NEW	FC Simplex female > female	4.0	14.9
	86325	FireWire 4 pin > FireWire 4 pin		16.8
	86324	FireWire 6 pin > FireWire 6 pin		16.8
86366	86316	HDMI female > HDMI female		17.4
86358	86359	HDMI female > HDMI female 90°		16.8
	86326+328	HDMI female > HDMI female with cable		16.8
86352	86302	IEC female > F female	10.6	16.3
	86334	IEC female > F female FM		16.8
	86362	IEC male > F female	10.6	16.3
	86335	IEC male > F female FM		16.8
	86322	Stereo Jack 3.5 mm female > female		16.8
	86336	Stereo Jack 3.5 mm 3 pin female > female gold plated		19.2
86383	86363 NEW	Klinke 3,5mm 4 pin female > female gold plated		18.0
	86347+357	LC Duplex female > female		17.9
86179 (86479 set)		LSA Cat.6A compact > RJ45 female		14.5
86374		Mini Displayport female > female with cable		16.8
86338		Mini-DIN 4 pin (S-Video) female > female	8.0	16.0
86339		Mini-DIN 6 pin (PS/2) female > female		16.6
86346		MTRJ female > female		22.0
	86303+304	Binding post > Thread nut	10.3	16.3
86390	86380	RJ12 female > female Cat.3		16.8
86168	86198	RJ12 female > LSA Cat.3		21.0
	86204+210	RJ45 female > female Cat.5e+Cat.6 compact		15.8
	86141+166	RJ45 female > female Cat.6+Cat.6A		17.1
	86154	RJ45 female > LSA toolfree Cat.6		18.0
	86340-345	RJ45 female > LSA toolfree Cat.6 UTP		18.1
	86205+405	RJ45 female > LSA toolfree Cat.6A		16.0
	86179+479	RJ45 female > LSA toolfree Cat.6A compact		14.5
	86404	RJ45 Secure Cat.6 > LSA		17.3
86381	86379 NEW	RJ45 female > RJ45 female Cat.6 UTP		16.1
86408	NEW	RJ45 female > RJ45 female Cat.6A metal		16.8
86288	NEW	RJ45 female Cat.6A		16.5
86488	NEW	RJ45 female Cat.8		16.4
86267	86266	RJ45 female > LSA Cat.6A UTP		16.0
	86356	RP-SMA female > RP-SMA female	7.1	16.3
	86331	SC Simplex female > female		17.8
	86365	SMA female > SMA female	7.1	16.3
	86348	ST Simplex female > female	13.6	17.8
	86323	Terminal Block > Terminal Block	5.4	16.8
	86337	Toslink female > female		16.6
86367	86317	USB 2.0 A female > USB 2.0 A female		16.8
86354	86364	USB 2.0 A female > USB 2.0 A female 90°		16.8
	86327+329	USB 2.0 A female > USB 2.0 A female with cable		16.8
86370	86320	USB 2.0 A female > USB 2.0 B female		16.8
86369	86319	USB 3.0 A female > USB 3.0 A female		17.3
86360	86361	USB 3.0 A female > USB 3.0 A female 90°		16.8
86375		USB 3.0 A female > USB 3.0 A male with cable		17.8

Mounts

black	white	name	width
43259	43309	10" Patch Panel 12 Port	18.5
43326	43327	10" Patch Panel 12 Port metal	18.0
43277	43302	19" Patch Panel 24 Port	18.5
43278		19" Patch Panel 24 Port staggered	18.5
43340	NEW	19" Patch Panel 24 Port rotatable	17.2
43280		19" Patch Panel 48 Port 1 HE	*
43338	43336 NEW	Desktop Patch Panel 8 Port	17.2
43339	43335 NEW	Desktop Patch Panel 12 Port	17.2
	86202	Wall Outlet 2 Port	21.5
	86219	Wall Outlet 2 Port compact	14.9
	86194	Wall Outlet 3 Port	18.2
	86212	Mounting 1 Port for DIN rail	17.4
	86414 NEW	Mounting 1 Port for DIN rail 180°	17.4
	86232	Mounting 1 Port for DIN rail shielded	17.4
86259	NEW	Mounting 1 Port for DIN rail	23.0
86255	NEW	Mounting 2 Port for DIN rail	19.0
86277	86276	Mounting 3 Port in-desk 60 mm	17.2
86282	86283	Mounting 4 Port in-desk 80 mm	17.5
86273		Mounting 6 Port for 5.25 PC mounting	23.2
86280		Mounting 6 Port for floor tank	18.0
86268	86218	Mounting 6 Port Multimedia Panel	18.5
86274		Mounting 6 Port Panel Appliance	17.0
86281		Mounting 9 Port for floor tank	18.0
86257	86207	Surface Mounted Box 2 Port	26.0
	86236	Surface Mounted Box 2 Port with dust cover	27.0
	86262	Surface Mounted Box 3 Port closed	25.0
	86208	Surface Mounted Box 4 Port	26.0
	86227	Surface Mounted Box 6 Port	26.0
	86209	Surface Mounted Box 8 Port	26.0
	86172	Surface Mounted Box 12 Port	23.6

* only suitable for 86179+479 and 86205+405

in mm

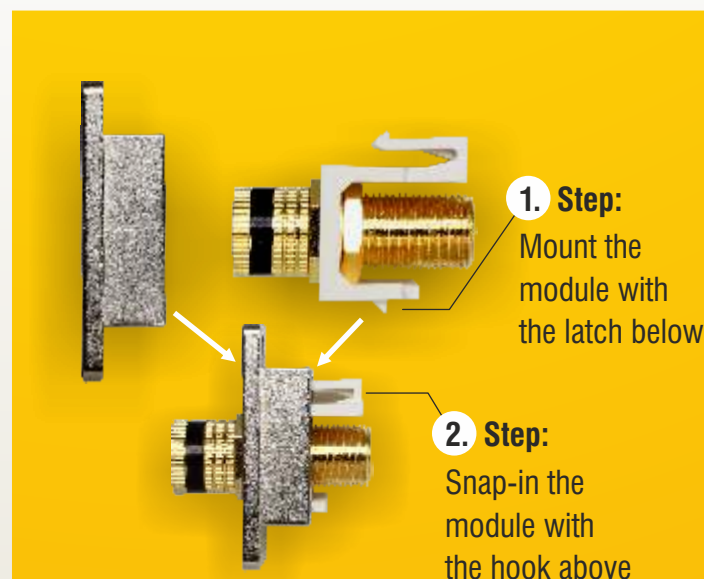

Snap-In mounting (Keystone module with mounting)



1 86219 Keystone Wall Outlet 2 Port compact

- 45° angle of Keystone modules
- Dust covers
- Integrated name plate
- Mounting holes 60 mm
- Colour: pure white RAL 9010
- Design suitable central plate 50 x 50 mm
- Dimensions (LxWxH): 80 x 80 x 25.7 mm



2 86262 Keystone Surface Mounted Box 3 Port

- Cable routing 90°, 180°, 270° or in-wall
- Dust cover for the Keystone ports and connected cables
- Cable restraints for the connected cables
- Colour: pure white RAL 9010
- Dimensions (LxWxH): ca. 120 x 82 x 31 mm



3 43259 ● 43309 ○ 10" Keystone Patch Panel 12 Port

- For mounting in 10" cabinets
- Metal panel with plastic front bezel
- Integrated name plate
- Dimensions (LxWxH): ca. 255 x 44 x 12 mm



4 86212 Keystone Mounting for DIN rail 1 Port

- One Keystone port 19.2 x 14.9 mm
- Mounting for 35 mm DIN rail
- Integrated name plate
- Dimensions (LxWxH): ca. 65.0 x 18.0 x 78.5 mm
- Stackable



86232 Keystone Mounting for DIN rail shielded 1 Port

- Same as item 86212
- Sheet metal for grounding Keystone with metal housing to the DIN rail
- Dimensions (LxWxH): 78.5 x 65 x 18 mm

86414 Keystone Mounting for DIN rail 180°

- One Keystone port 19.2 x 14.9 mm
- Mounting for 35 mm DIN rail
- Integrated name plate
- Dimensions (LxWxH): 78.5 x 65.0 x 18.0 mm

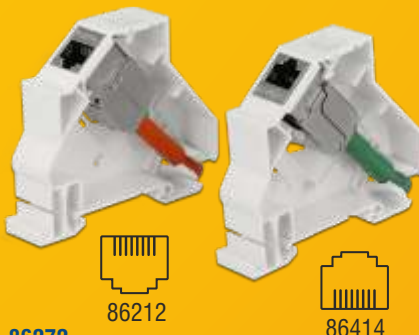

5 86272 Cover for Keystone DIN rail Mounting

- Cover can be used as an end plate for the Delock Keystone DIN rail mounts 86212 and 86232
- Dimensions (LxWxH): ca. 74.8 x 65.1 x 1.5 mm

6 86268 ● 86218 ○



Keystone Multimedia Panel 6 Port

- For mounting on tables, furniture or walls
- 45° angled keystone panel
- Integrated name plate
- Dimensions (LxWxH): ca. 130 x 65 x 49 mm

7 86202 Keystone Wall Outlet 2 Port

- 40° angle of Keystone modules
- Dust covers
- Integrated name plate
- Colour: pure white RAL 9010
- Mounting holes 60 mm
- Dimensions (LxWxH): ca. 80 x 80 x 23.6 mm



86194 Keystone Wall Outlet 3 Port compact

- 45° angle of Keystone modules
- Dust covers
- Integrated name plate
- Mounting holes 60 mm
- Design suitable central plate
- Colour: pure white RAL 9010
- Dimensions (LxWxH): 80 x 80 x 25.8 mm



8 86213 / 86413 Set of 4 Keystone Mounting for enclosures 1 Port

- Panel Cut-out (WxH): 22.8 x 16.8 mm
- Material: die cast zinc
- Dimensions (LxWxH): ca. 35.5 x 19.1 x 9.8 mm



86275 Keystone Mounting 1 Port for D-type

- 1 Keystone port 19.2 x 14.9 mm
- Panel cut-out (diameter): ca. 23.6 mm
- Two mounting holes for screws, spacing 30.6 mm, with M3 thread
- Dimensions (LxWxH): ca. 31 x 26 x 9.8 mm



example for 86275

Keystone installation options

Patch Panel and Mounts for walls, floors and table



43303

Keystone 10" Wallmount Rack

- For mounting of 10" devices with 1 U (max. 7 cm depth)
- With hinge and cover plate
- Metal case
- Dimensions (LxWxH): ca. 26.4 x 7.6 x 4.4 cm



43338 ● 43336 ○

Keystone Desktop Patch Panel 8 Port

43339 ● 43335 ○

Keystone Desktop Patch Panel 12 Port

- 12 Keystone ports 19.2 x 14.9 mm
- Cable routing 180°
- Colour: jet black RAL 9005
- Metal housing
- Shielded
- 2 DIN-rail clips



86274

Keystone Mounting Panel 6 Port for wall

- 6 Keystone ports 19.2 x 14.9 mm
- Integrated name plate
- Two holes with fixing clips, distance 118 mm
- Material: metal
- Dimensions (LxWxH): ca. 130.0 x 29.3 x 19.8 mm

86207 2 Port
86208 4 Port
86227 6 Port
86209 8 Port



86226

Keystone Surface Mounted Box 1 Port

- Cable routing 180°
- Dimensions (LxWxH): ca. 59 x 35.5 x 28.5 mm



86273

Keystone 5.25" Multipanel 6 Port

- 6 Keystone ports 19.2 x 14.9 mm
- For 5.25" bay mounting
- Material: Metal panel with plastic brackets
- Dimensions (LxWxH): ca. 146 x 80.2 x 42.2 mm

43340

19" Keystone Patch Panel 24 Port rotatable

- 24 Keystone ports 19.2 x 14.9 mm
- Rotatable bearing of the Keystone ports
- For mounting in 19" racks, 1 U
- Material: Metal panel with plastic front bezel
- Dimensions (LxWxH): ca. 482.6 x 44.0 x 11.5 mm

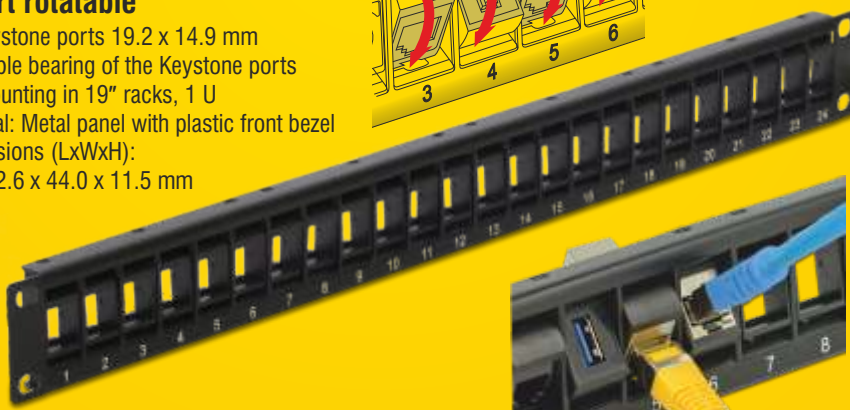
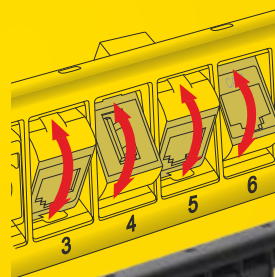

43277 ● 43302 ○

19" Keystone Patch Panel 24 Port with strain relief

- Printed name plate
- Dimensions (LxWxH): ca. 482 x 92 x 44 mm



43278

19" Keystone Patch Panel 24 Port staggered with strain relief

- Printed name plate
- Dimensions (LxWxH): ca. 482 x 93 x 44 mm



Staggered arrangement for low crosstalk



43326 ● 43327 ○

10" Keystone Patch Panel 12 Port

- For mounting in 10" cabinets, 1 U
- Integrated name plate
- Material: metal
- Dimensions (LxWxH): ca. 254 x 43.6 x 9.9 mm



43259 ● 43309 ○

10" Keystone Patch Panel 12 Port

- For mounting in 10" cabinets, 1 U
- Integrated name plate
- Material: Metal panel with plastic front bezel
- Dimensions (LxWxH): ca. 255 x 44 x 12 mm



Network modules

86205
RJ45 female >
LSA Cat.6A

86405 Set of 24



toolfree

86179
RJ45 female >
LSA Cat.6A
compact

86479 Set of 24



toolfree



43280

19" Keystone Patch Panel 48 Port with strain relief

- Printed name plate
- For 86205 and 86179
- Dimensions (LxWxH): ca. 48.2 x 4.4 x 15 cm



86277 ● **86276** ○

Keystone Mounting 3 Port in-desk

- 3 Keystone ports 19.2 x 14.8 mm
- Mounting diameter: ca. 60 mm
- Mounting depth (with module): ca. 30 mm



86259

Keystone Metal Holder 1 Port for DIN rail

- 1 Keystone port 19.2 x 14.9 mm
- Mounting for 35 mm DIN rail
- 70° angled
- Material: metal
- Dimensions (LxWxH): ca. 23 x 39 x 37 mm



86255

Keystone Metal Holder 2 Port for DIN rail

- 2 Keystone ports 19.2 x 14.9 mm
- Dimensions (LxWxH): ca. 42 x 39 x 37 mm



86282 ● **86283** ○

Keystone Mounting 4 Port in-desk

- 4 Keystone ports 19.2 x 14.8 mm
- Mounting diameter: ca. 80 mm
- Mounting depth (with module): ca. 30 mm
- Dimensions: Diameter (total): ca. 95 mm
Height (total): ca. 23 mm

Useful tool for connecting module and cable

Connect a network cable quickly and easily to the RJ45 Keystone module 86205 or 86179. The single wires need to be preassembled in the module, then the module is inserted in the tool and pressed. Thereby all the wires are simultaneously contacted and the excess cable ends are cut off.

86211

Crimping Tool for 86205 + 86179

- Metal pliers with plastic handles and lock
- Tool interchangeable
- Bag dimensions (LxWxH): ca. 22.5 x 17 x 5.5 cm



Tool interchangeable



Bit on top for 86205



Practical bage



Bit on top for 86179



86280 for 6 Ports 86281 for 9 Ports Keystone Mounting 6 Port / 9 Port for floor tank

- For 6 Keystone modules, easy snap-in mounting
- For mounting in floor tanks
- Suitable only for narrow modules up to 18 mm

86194

Keystone Wall Outlet 3 port compact

- 45° angle of Keystone modules
- Dust covers
- Integrated name plate
- Mounting holes 60 mm
- Design suitable central plate



Cat.8



Delock presents for the first time two GHMT-certified products for category -8- cabling (Cat.8) in networks

The field assembly RJ45-plug (Delock 86485) and the RJ45-Keystone-module (Delock 86488) meet modern requirements, in combination with Cat.8 network cables, for 25 and 40 Gbps Ethernet connections in length up to 30 meters. The both Delock components are therefore in data centers and also in office cabling optimally usable.

NEW
RJ45 Cat.8



86485

RJ45 Plug field assembly Cat.8 metal

- Connectors: 1 x RJ45 plug
- Cable routing 180°
- Shielded (STP)
- Cat.8 specification
- **GHMT certified: 2 Connector Channel Link ISO/IEC TR 11801-9901 Ed.1.0 (2014-08)**
- Material: zinc die cast
- TIA-568A/B pinout
- For solid or stranded wire up to 0.644 mm (22 - 24 AWG)
- For cable diameter from 6.0 - 8.5 mm
- Dimensions (LxWxH): ca. 62.2 x 18.4 x 13.8 mm



86488

Keystone Module RJ45 jack Cat.8 toolfree

- Connectors:
external: 1 x RJ45 jack (8P/8C) >
internal: LSA (toolless)
- Shielded (STP)
- Cat.8 specification
- **GHMT certified: 2 Connector Channel Link ISO/IEC TR 11801-9901 Ed.1.0 (2014-08)**
- Material: zinc die cast
- For solid or stranded wire up to 0.644 mm (22 - 24 AWG)
- For cable diameter from 5.5 - 9.0 mm
- For Keystone ports with 19.2 x 14.9 mm
- Dimensions (LxWxH): ca. 37.4 x 16.5 x 22.5 mm



Secure with system



The new **Delock Secure RJ45 module** with integrated security mechanism has two functions:

- 1 The socket can be **blocked**
- 2 The patch cable can be **interlocked** and is protected against removal.



For locking and unlocking the separately available tool **86411** is required.



86404

Keystone RJ45 Secure Cat.6 > LSA

- Shielded (Cat.6)
- Dimensions (LxWxH):
ca. 38.5 x 22.3 x 17.3 mm

86411

Keystone Tool RJ45 Secure

- Dimensions (LxWxH):
ca. 80.5 x 23 x 11 mm



Easy USB 2.0 A



The **EASY USB** socket is different to the usual 4 pin socket because it has **8 pins**. The benefit is that a USB plug can be plugged in the EASY USB socket in both directions.

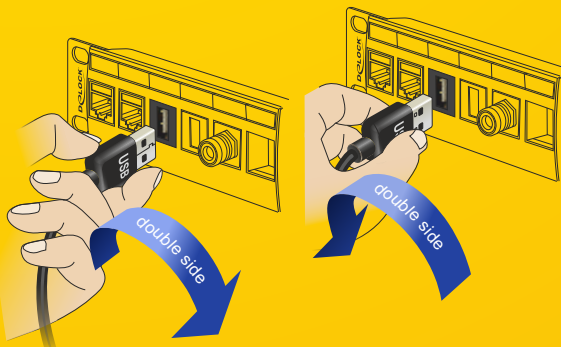

A USB 2.0 socket with **8 pins** instead of conventional 4 Pins

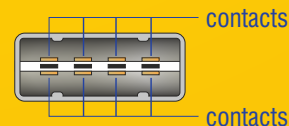

86353 ● **86368** ○
EASY-USB 2.0 A female >
EASY-USB 2.0 A female

